



15 TRAIE TWOAIE, NORTH SHORE ROAD
RAMSEY, IM8 3DB

£300,000
FREEHOLD

An Immaculate Spacious Modern 3 Double Bedroom Property In A Sought After Location In The Heart of Ramsey Town Centre



• Entrance Porch, Hallway with Modern Cloakroom/WC and Separate Utility Room • Spacious Open Plan Lounge/Dining Area and Kitchen With Built In AEG Oven, Induction Hob, • Microwave, Fridge Freezer, and Dish Washer • Tiled Wood Effect Flooring and LED Built In Ceiling Lights • Double Doors Out To Patio and Rear Garden • 3 Good Sized Double Bedrooms • Spacious Contemporary Tiled Bathroom With Separate Bath and Separate Shower Unit • Gas Central Heating • Off Road Parking for 2 Cars • Rateable Value: For latest rateable value please contact the Rates Office on 685661



Overview

Located in the charming area of Traie Twoaie on North Shore Road, Ramsey, this delightful mid-terrace house offers a perfect blend of modern living and comfort. Built in 2016, the property boasts a contemporary design that is both stylish and functional, making it an ideal choice for families or professionals seeking a welcoming home.

With three well-proportioned bedrooms, there is ample space for relaxation and rest. Each room is designed to maximise natural light, creating a warm and inviting atmosphere. The single bathroom is thoughtfully appointed, providing convenience for daily routines.

Additional Information

Rateable Value: For latest rateable value please contact the Rates Office on 685661

Inclusions : TBC

School District: Ramsey Primary School and Ramsey Grammar School

Directions

Travelling From Parliament Square towards Bowring Road Turn right down North Shore Road. Take the next turning on your right in to Traie Twoaie and follow the road round and

Number 15 Can be found on the Left Hand Side clearly marked by our board.



GROUND FLOOR
478 sq.ft. (44.4 sq.m.) approx.

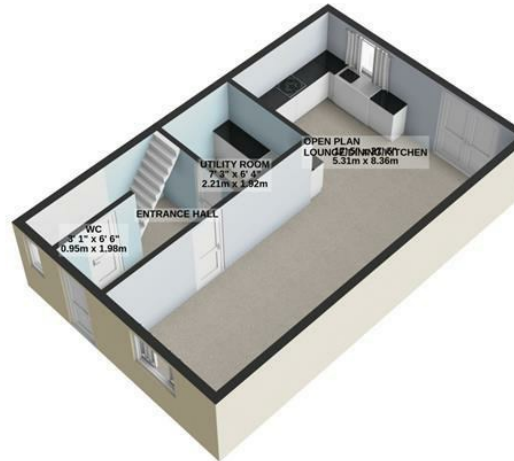

1ST FLOOR
478 sq.ft. (44.4 sq.m.) approx.

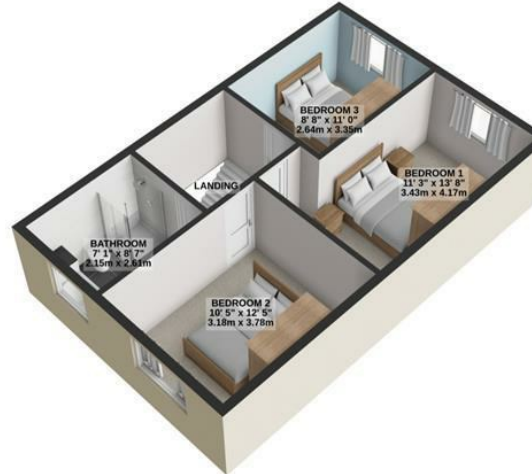

TOTAL FLOOR AREA : 955 sq.ft. (88.8 sq.m.) approx.

For illustrative purposes only. Decorative finishes, fixtures, fittings and furnishings do not represent the current state of the property. Measurements are approximate. Not to scale.
Made with Metropix © 2024